

**xyzmo SIGNificant
Healthcare Solution**

**xyzmo SIGNificant for Optimized Patient Admission
Simple, Secure Electronic Signature Solutions**

Hospitals and healthcare institutions processes include a variety of documents that need to be signed, each with their own unique requirements. xyzmo SIGNificant provides the flexibility needed to support the diverse applications of the healthcare sector and accelerates the transition to electronic records, thereby increasing employee efficiency and enhancing patient service and safety. We offer expedited signing solutions that streamline general hospital and emergency department patient experiences, spanning from admission to discharging procedures.

Think of this simple process and imagine the benefits!

Nothing is easier than completing a form automatically simply by scanning/swiping the patient's insurance card or driver's license to obtain important and possibly confidential information. Any additional required data can be captured via a soft keyboard or pin pad (for instance social security number). Signing and sealing healthcare forms and documents can now be performed electronically and these document can be automatically sent to the patient, using the provided email address. Verification of the authenticity/integrity of the documents and storage problems will no longer be an issue for hospitals or healthcare institutions and their patients.



Swipe or Scan
Driver's License/
Credit Card



Data Capture
Using a Soft Keyboard



Signature Capture
Using a Signature Pad,
Tablet PC, etc



Attach Document
Attach Scanned Passport, Drivers License or any other Document



Convert & Seal
Convert any Document
to PDF and Seal it

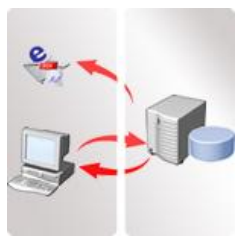

Email & Store
Send Documents Via
E-Mail, Store and
Retrieve Documents



Verify Documents
Verify Signed &
Sealed Documents
with a Single Click



Verify Signature
Comparing a Handwritten Signature Against a Pre-Enrolled Profile



**Guaranteed ROI
Within 12 Months!**

xyzmo SIGNificant Can Streamline Various Healthcare Scenarios :

- Patient admissions
- Physician prescription signing
- Physician orders
- Chart signing
- Integration into electronic medical records systems (EMRs)
- Emergency department information systems (EDIS)
- Mobile signing



Benefits of xyzmo SIGNificant's Technology for the Healthcare Sector

- Helps improve patient care by streamlining patient admission processes
- Significantly reduces patient waiting times
- Enormous cost savings due to labor reduction and the elimination of the need for printing, faxing, scanning, storage, shipping, shredding & mailing/courier
- Eliminates processing delays, errors, lost documents, etc. associated with paper-based processes
- Enables a true paperless workflow
- Reduces the risk of fraud
- Easily integrates into existing EMRs, EDIS, DMS, ERP and CRM Systems due to web-services interfaces
- Enables compliancy with current e-signature legislation (HIPAA, UETA, E-SIGN, FIPS, etc.)
- Offline signing capability for mobile workers
- Optional real-time biometric signature authentication
- Hardware independent
- Hardware independent

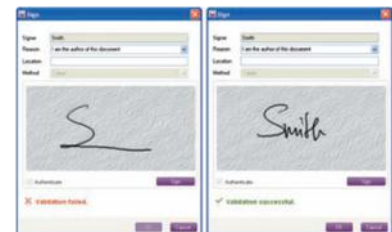

xyzmo SIGNificant gives your organization the chance to reap the benefits of having a legally binding document in electronic form

Our Solutions Can Easily Integrate With

- Electronic Medical Records systems: EPIC, Eclipsys, Cerner, Siemens etc.
- EDIS such as Picis



Different Hardware Supported:



17" touch-screen/
digital pen display

and



All-in-one magnetic card
reader/barcode scanner



All-in-one portable
wireless device

or



Fixed stand magnetic card reader, signa-
ture capture device and portable barcode
scanner



Low-cost signature
pad

and



All-in-one magnetic card
reader/ barcode scanner

xyzmo SIGNificant's products offer compliancy with the following

- **HIPAA** Health Insurance Portability and Accountability Act (HIPAA). HIPAA provides health insurance coverage for workers and their families when they change or lose their jobs. In addition, it requires the establishment of national standards for electronic health care transactions and national identifiers for providers, health insurance plans and employers.
- **ESIGN Act** (Electronic Signatures in Global and National Commerce Act)
- **UETA** (Uniform Electronic Transactions Act)
- **SOX** (Sarbanes-Oxley Act)
- **The Security Rule of 2003** The Security Rule deals with Electronic Protected Health Information and complement the Privacy Rule which is part of the HIPAA.

About xyzmo SIGNificant Group

xyzmo SIGNificant Group is a leading provider of electronic and digital signature solutions, offering an exclusive product line the equips organizations into a secured paperless environment.

Our legally compliant signature solutions, including the digital stamp and the personal electronic and biometric signature, represent the basis for integrated digital processes.

xyzmo SIGNificant products are being used by leading companies in more than 10 countries and in various industries such as: telecommunications, banking, insurance, healthcare, pharmaceutical and others.

Thanks to our signature solutions, signing and stamping remain as easy as ever, but are performed directly within the electronic document and can be integrated into any existing application or document workflow procedure.



This document is for information only and is subject to change without notice, Technical changes, misprints, errors expected. All rights reserved.